

Prior to changing the Hemolung Cartridge, prepare the following supplies:

- Disinfectant Solution
- Hemolung Cartridge Kit
- Sterile Scissors
- Hemolung Rinseback Kit
- 500 mL bag of saline
- 30 mL syringes
- Barb to Barb Connectors



If blood rinse back is desired prior to changing the Cartridge, follow the procedures for returning the patient's blood in the Rinse Back reference guide. Blood should only be returned to the body if there are no signs of clotting or thrombosis.

Change Cartridge following these steps:

**1 Prime Hemolung Cartridge** - Assemble, prime, and recirculate a new Hemolung Cartridge (with new blood tubing). See Setup and Priming reference guide for instructions.



If a second Hemolung Controller is not available for priming the new circuit, Step 1 will be delayed until after the existing blood circuit has been disconnected from the Catheter (Step 7). In this case, Catheter patency must be preserved while priming the new circuit. Barb to Luer connectors can be used to connect a continuous infusion lines to the catheter lumens to prevent clotting. If the Catheter needs to be locked, use the provided caps.

**2 Prepare Syringes** - Fill the 30 mL syringes with normal saline. They will be used to provide irrigation during tubing connections.

**3 Disinfect Blood Tubes** - Clean and disinfect a 30 cm (12 in) length of each blood tube, starting at the catheter barb connector and moving toward the Hemolung Cartridge.

Use one of the following approved solutions:

- Aqueous based povidone iodine (Betadine<sup>®</sup>)
- Chlorhexidine Gluconate (Hibiclens<sup>®</sup>)
- Aqueous chlorhexidine topical solutions (Chloraprep<sup>®</sup>)

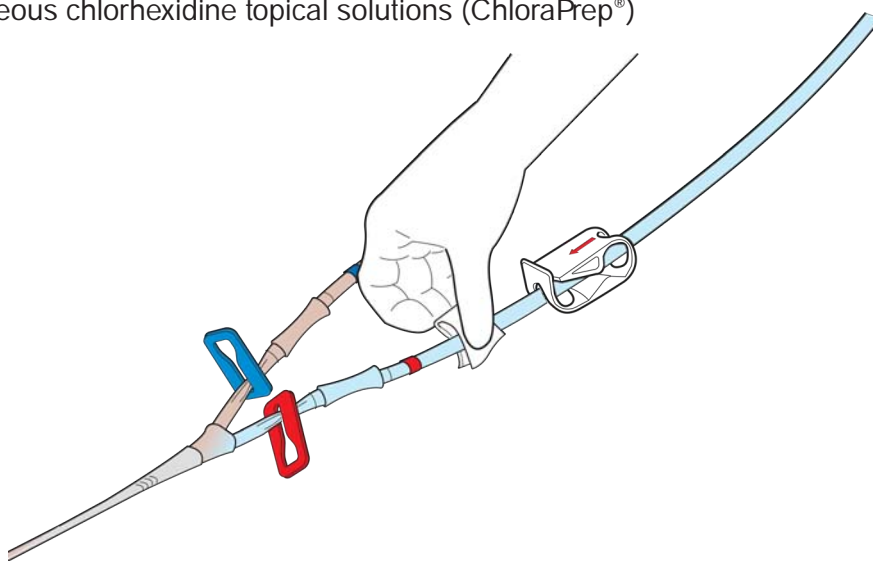

**4 Reduce Pump Speed** - Reduce the Hemolung Cartridge pump speed to approximately 500 RPM.

**5 Stop Pump** - Press and hold the **Pump Start/Stop** Key to stop the Hemolung Cartridge pump. Because stopping the blood flow increases the risk of clotting, the remaining steps should be completed as quickly as possible.

6 Close All Four (4) Clamps

7 Cut Blue and Red Tubing - Cut the tubing between the tubing clamp and the Catheter barb in the area that was previously cleaned.

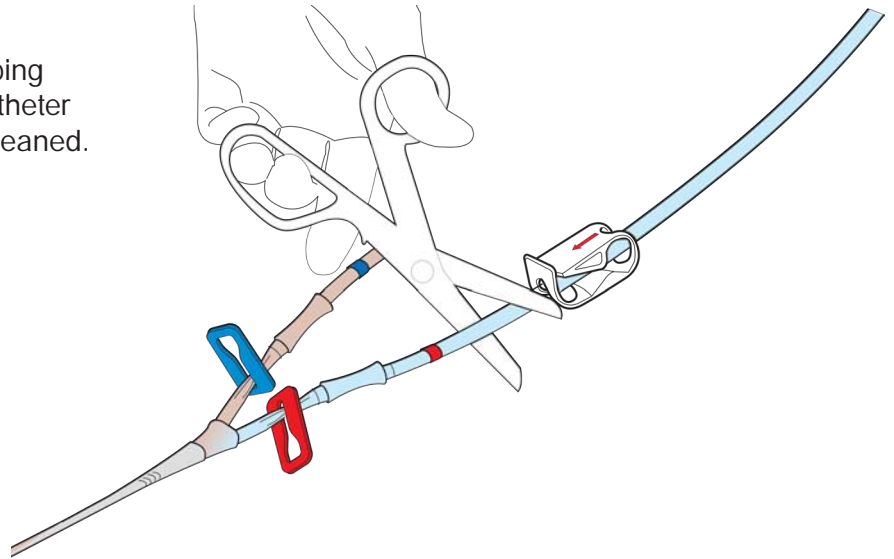

8 Insert Barb-Barb Connector - Attach the barb-barb connectors to the tubing remaining on the Catheter.

9 Connect New Cartridge - Using a wet-wet technique, connect the new Cartridge to the Catheter.

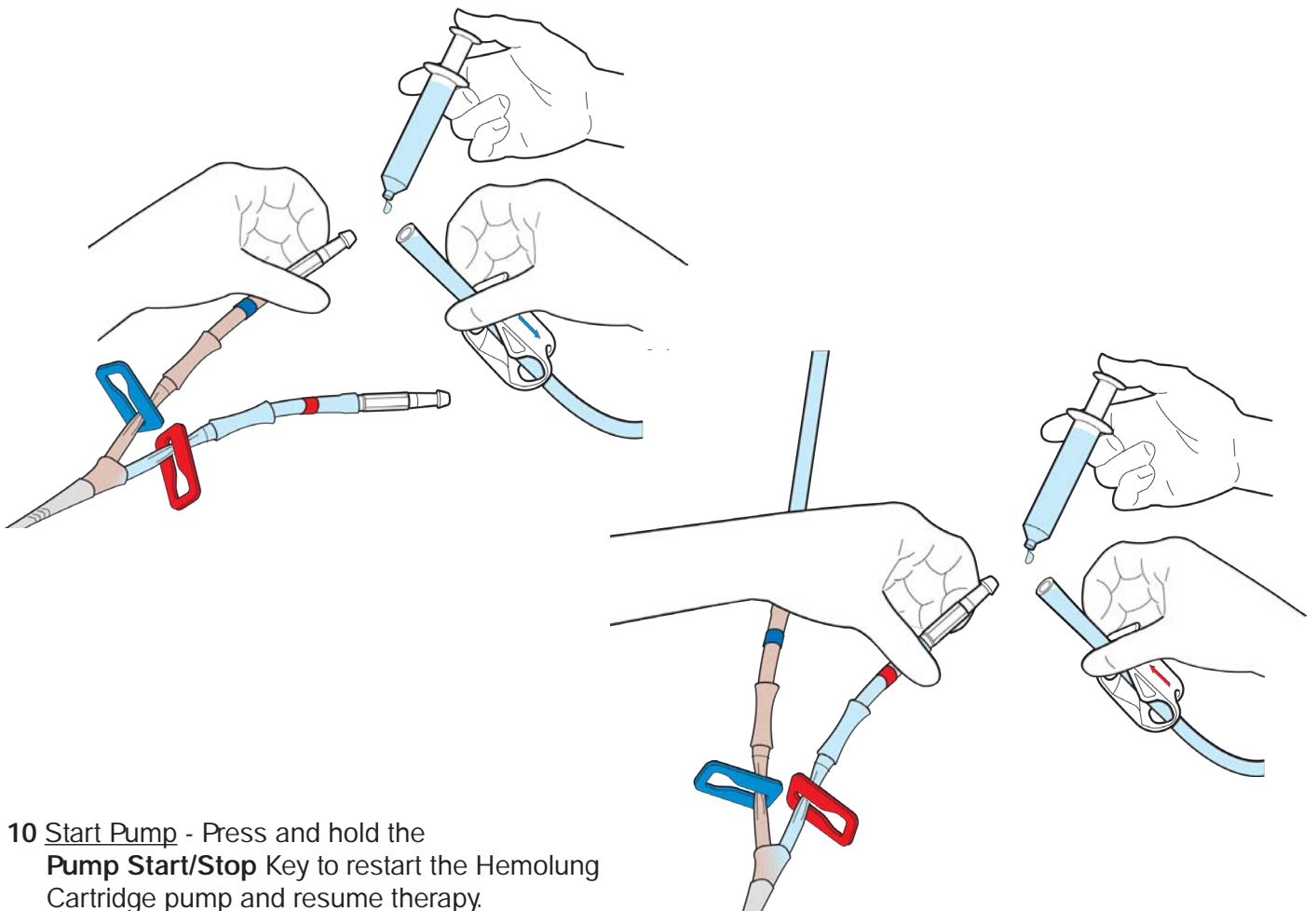

10 Start Pump - Press and hold the **Pump Start/Stop** Key to restart the Hemolung Cartridge pump and resume therapy.



Ensure the following:

- No Air in the Circuit
- Seal Flush Flow Rate of 30 mL/hr
- All Clamps are Open