

Before **Setup**, collect the following supplies:

- One 500 mL or 1000 mL bag/bottle of priming solution (0.9% NaCl with 1 U/mL heparin added)
- One 500 mL or 1000 mL bag of normal saline for seal flush

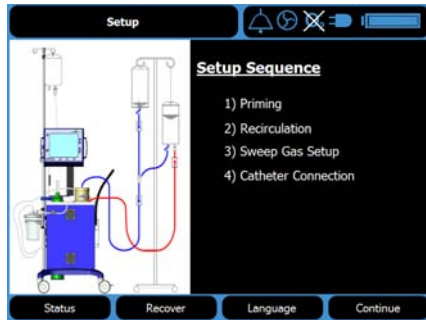

To begin:

- Plug in Controller
- Turn power switch ON
- Press Continue to set up New Circuit (press Recover to resume therapy)

Prime Circuit following these steps:

### 1 Remove Old Soda Lime

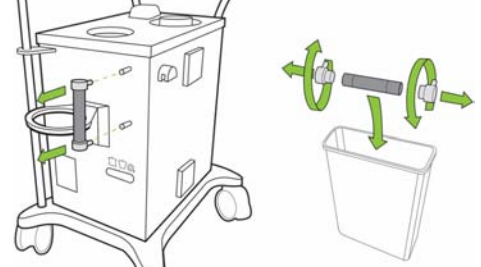

### 2 Assemble and Attach New Soda Lime Column

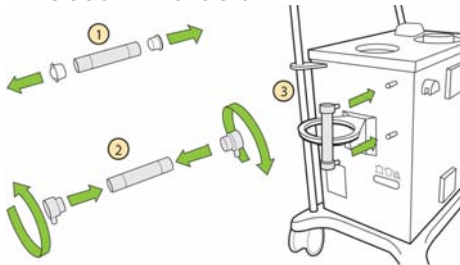

### 3 Hang the Saline for Seal Flush

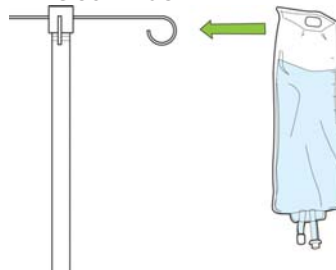

### 4 Set up Seal Flush

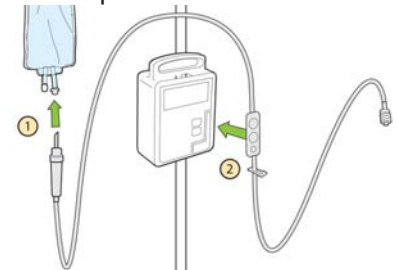

### 5 Connect IV Administration Set to Cartridge

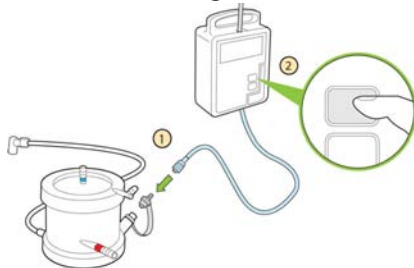

### 6 Prepare Priming Solution

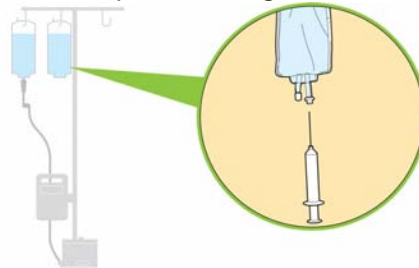

### 7 Hang Recirculation Bag

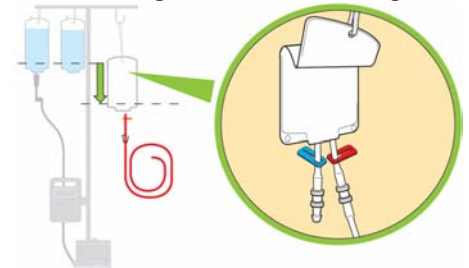

### 8 Connect Red Tube to Cartridge

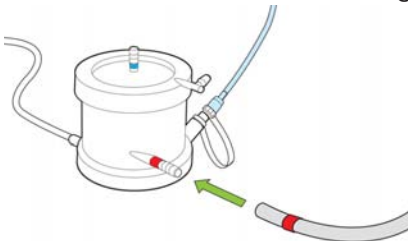

### 9 Spike the Priming Solution

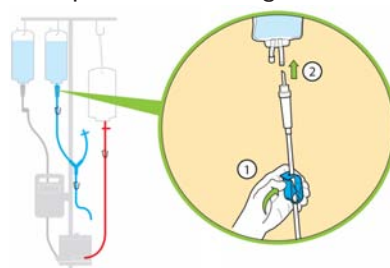

### 10 Connect Short Blue Tube to Recirculation Bag

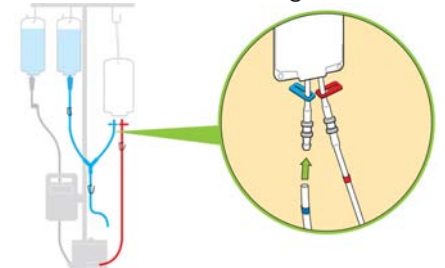

### 11 Connect Blue Tube to Cartridge

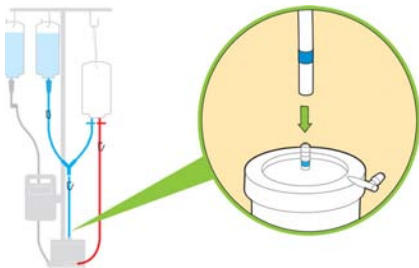

### 12 Fill the Drip Chamber

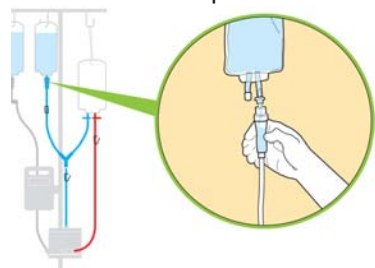

### 13 Close Blue Slide Clamps on Recirculation Bag

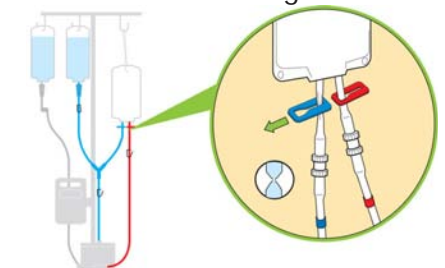

14 Prime the Cartridge

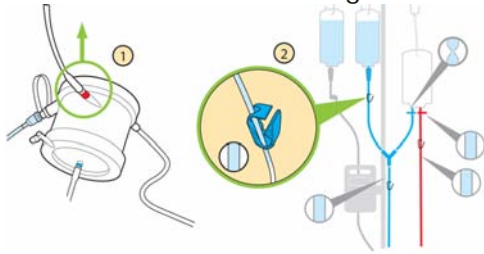

15 Use Gravity to Fill Cartridge

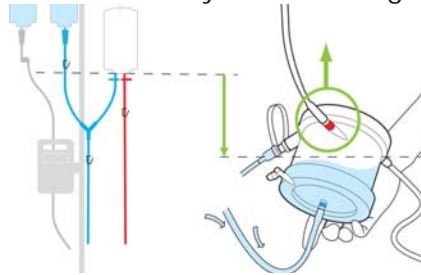

16 Fill the Cartridge

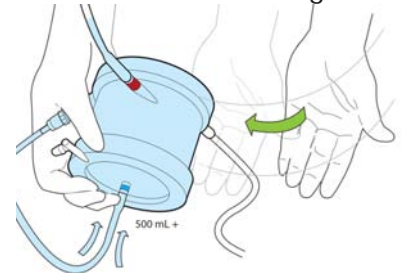

17 Close Blue Clamp on Priming Spike

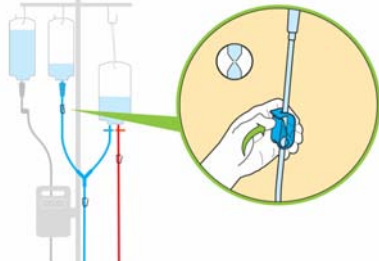

18 Open Blue Clamp on Recirculation Bag

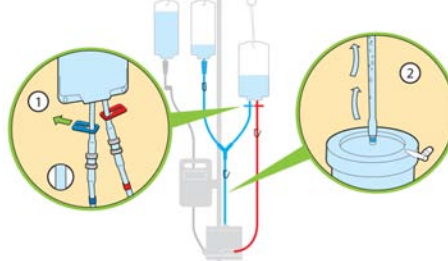

19 Check System for Air

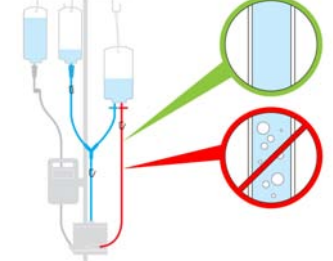

20 Apply Petroleum Jelly, Install Cartridge and Tubing

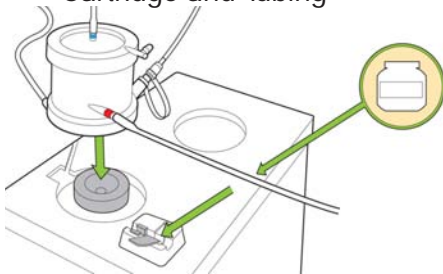

21 Assemble the Vacuum Canister

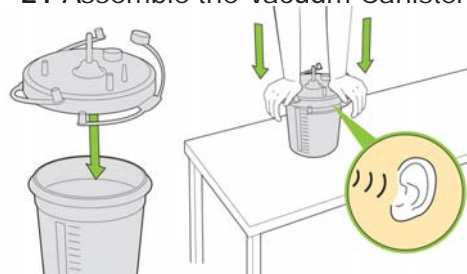

22 Close Unused Ports and Attach Vacuum Tubing



23 Connect Vacuum Canister to Controller

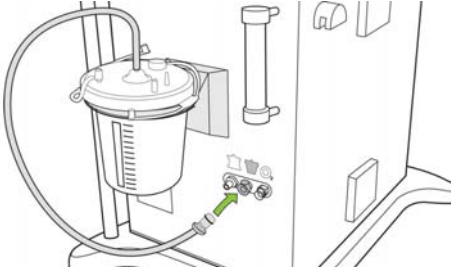

24 Install Silicone Tube in Purge Valve and Connect to Vacuum Canister

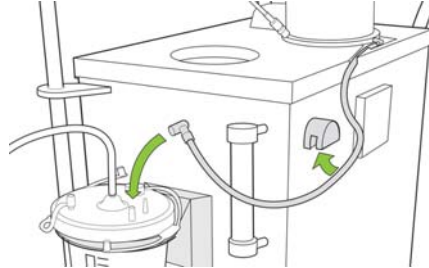

25 Connect Sweep Gas Supply Tube

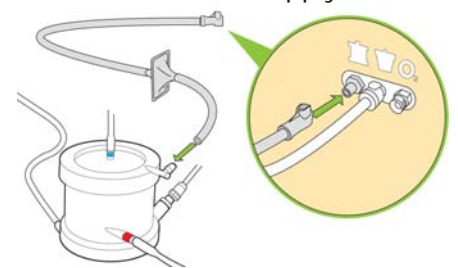

26 Check Tubing Connections and Check for Air

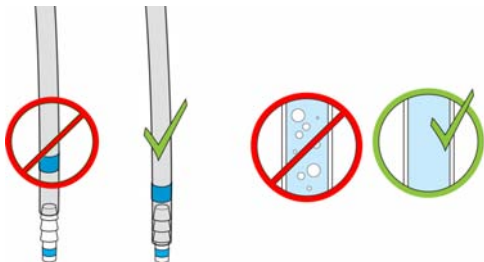

27 Start Recirculation



28 Allow System to Self-Test

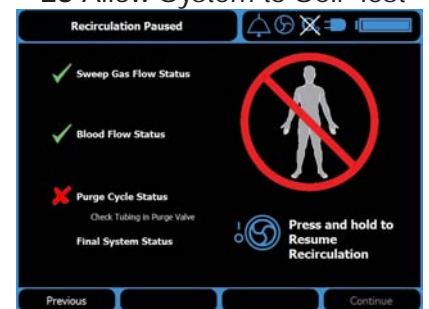

29 Successful Completion

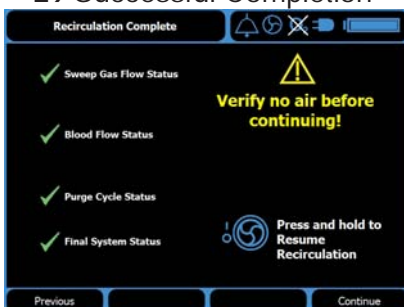

30 Select Sweep Gas Source

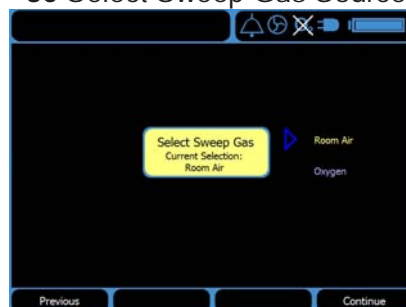

31 No Immediate Action Required on Controller

